

Bolts (per drive train)

---	---	#73	#47	#35	#31	---	#17	#18	#24
4x	4x	4x	4x	2x	1x	1x	5x	6x	5x (6x)
		for M4							
M5x16	M4x40		8x4x25mm Spacer	M8x16	M4x4	Key 3x3x8mm	7x15mm M4 Superstar Hub	7x17mm M4 for Hypa Hub	M4x10

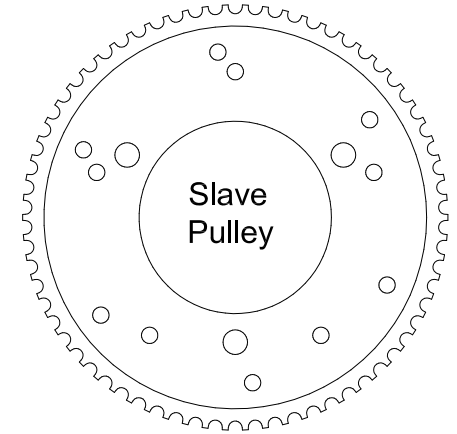

Tools needed

Lock paste

14mm 1 x

1 x 2.0 mm

1 x 3.0 mm

1 x 4.0 mm

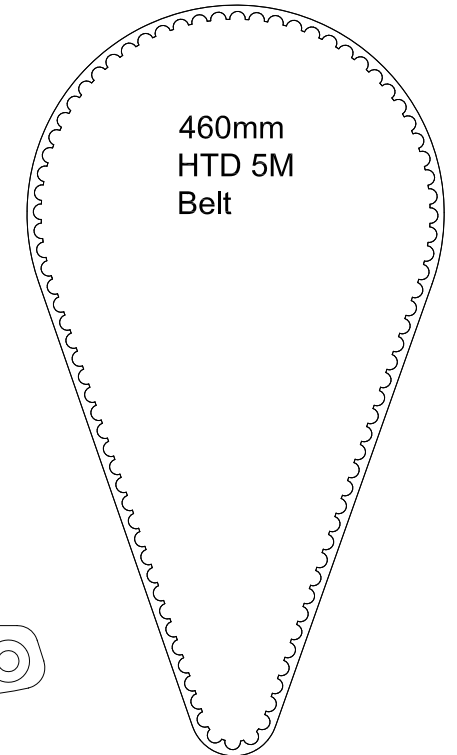
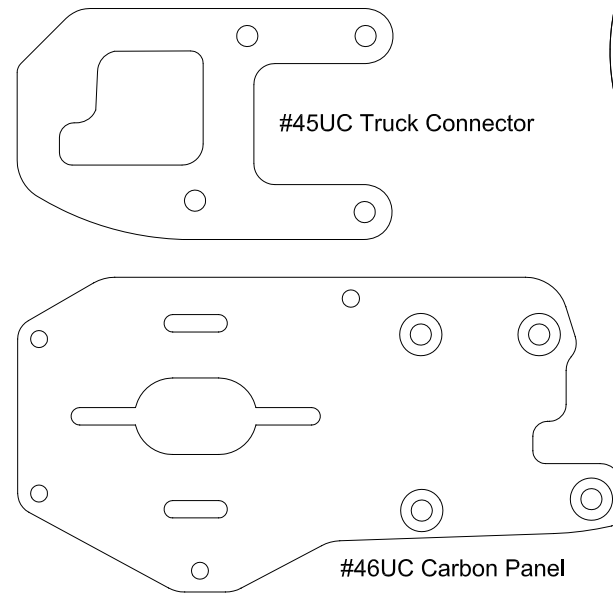

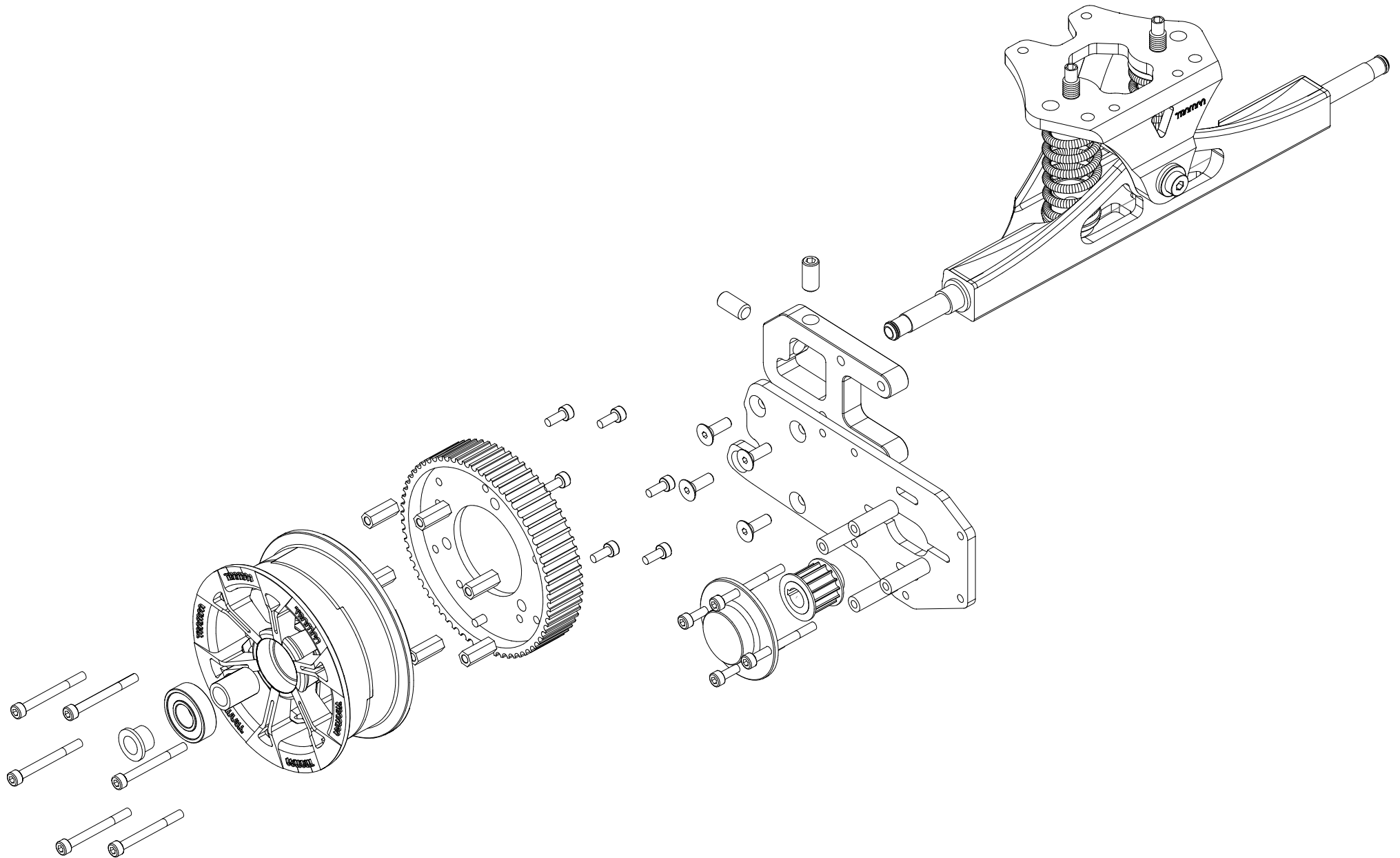

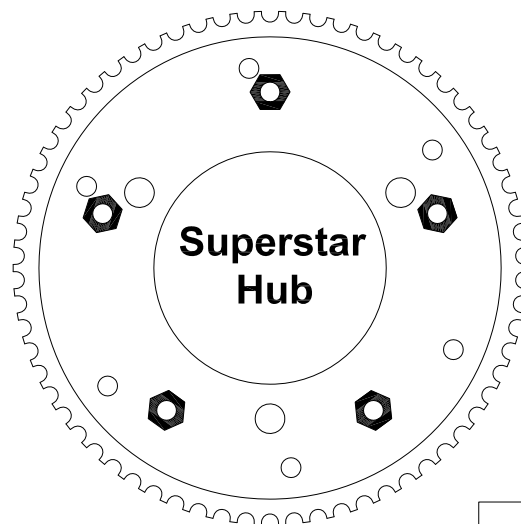
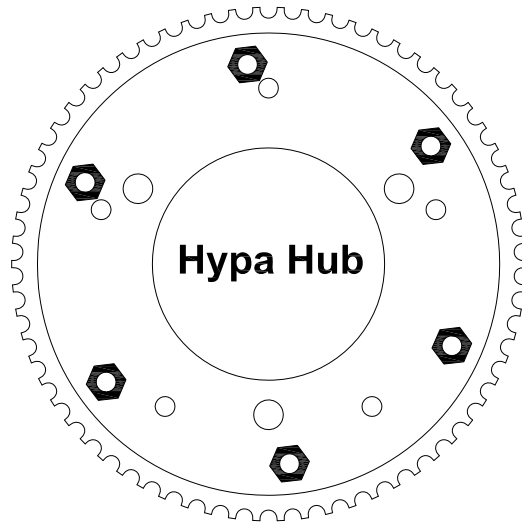

Spacer Nuts sit parallel to edge

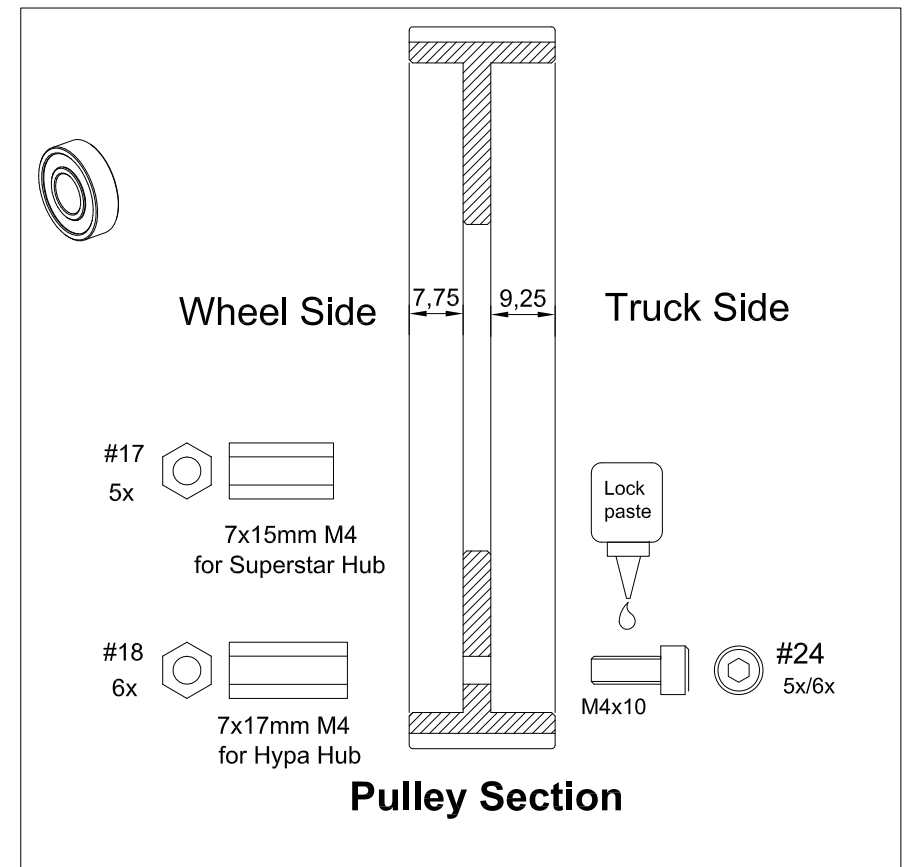
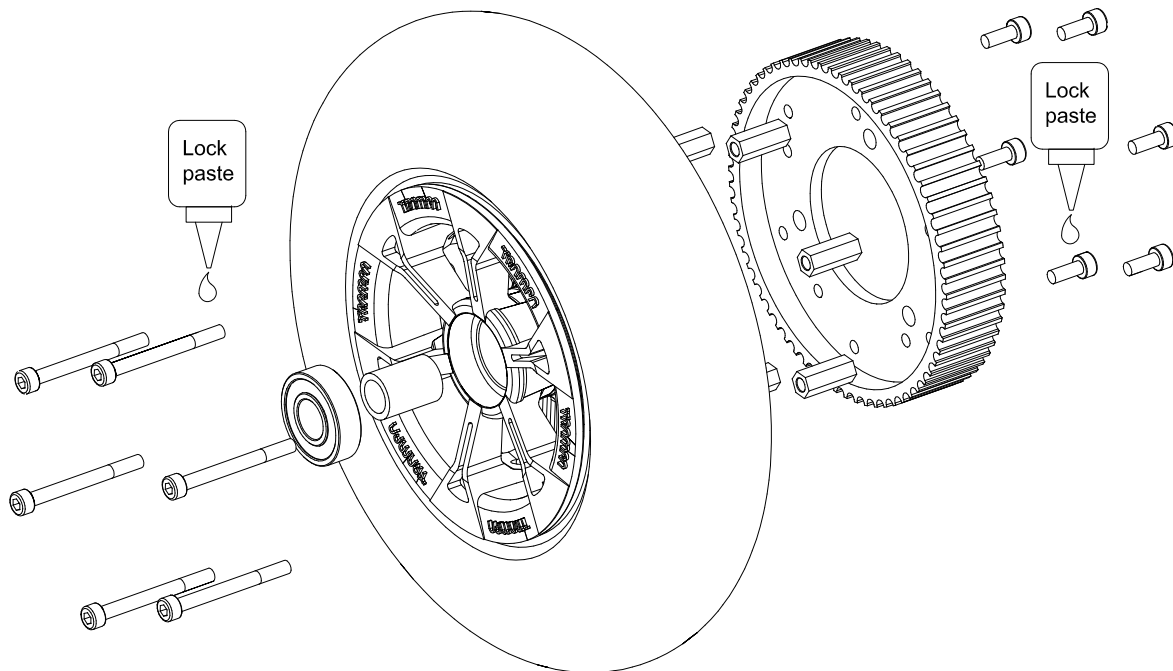
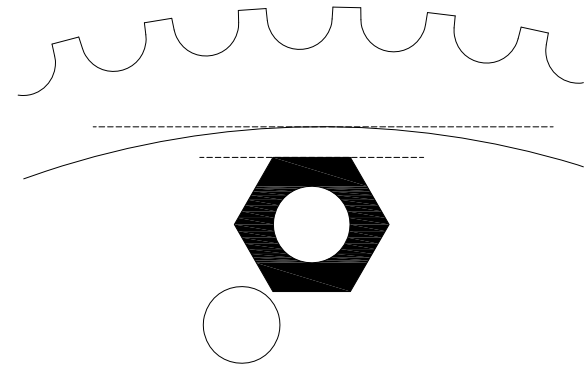

- 4x M5x16
- 2x #35, M8x16
- 1x #45UC Truck Connector
- #46UC Carbon Panel

2.1

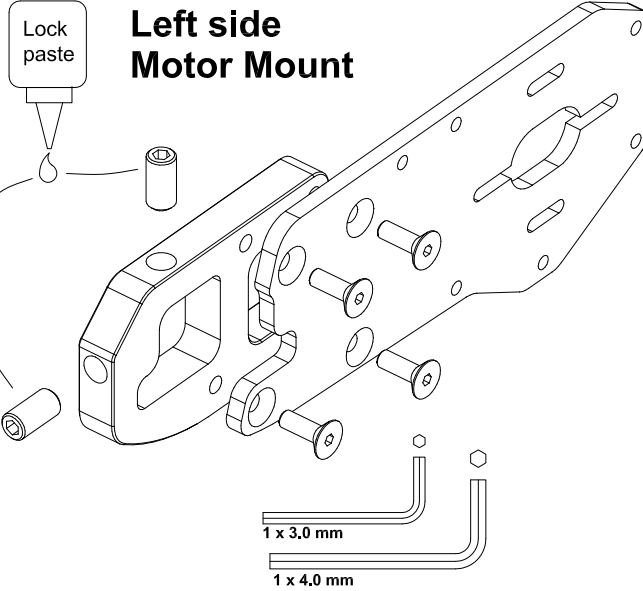

2.2

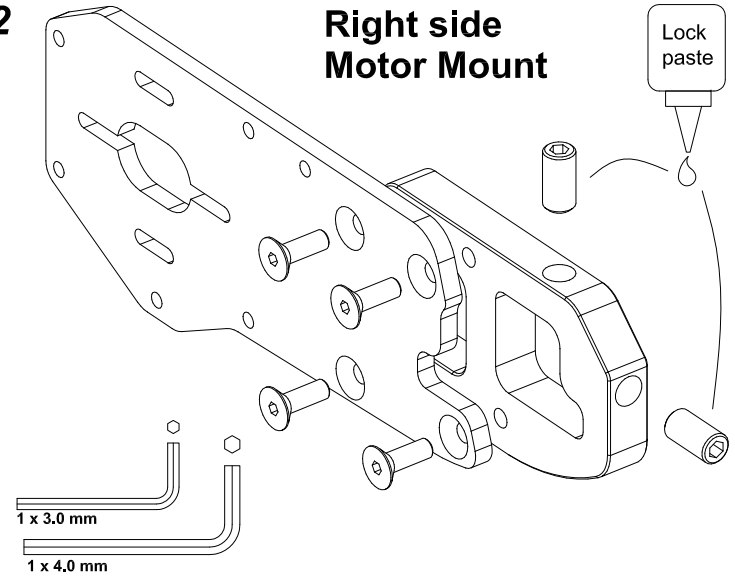

2.3

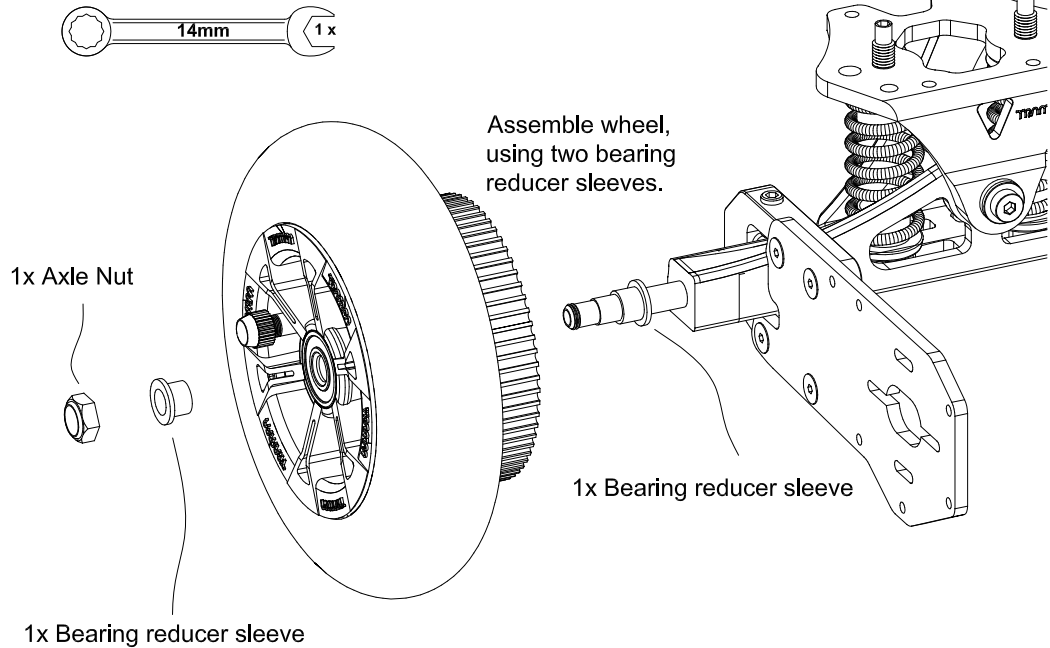

2.4

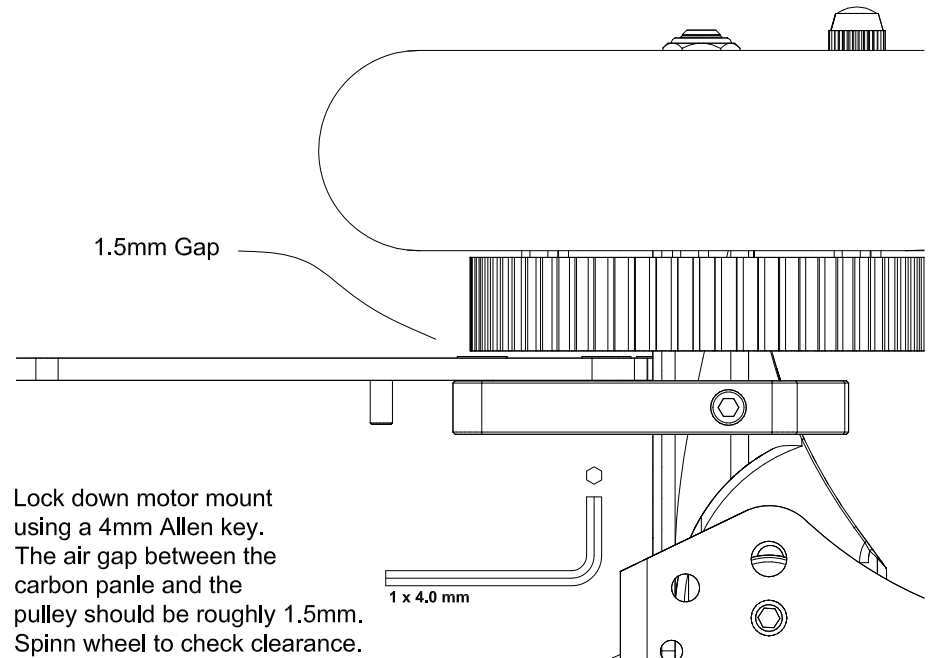

3.1

- Present the motor to the carbon panel and slide the brass bushing + two brass washers over the axle shaft.
- Insert the 8x3x3mm key into the corresponding slot on the motor shaft.
- Using lock paste, insert the M4 grub screw into the pulley. This screw can easily be cross threaded - stop winding if you feel any resistance.
- Slide the pulley onto the motor shaft making sure it interlocks with the 8x3x3mm key. Tolerances can be quite tight. The 8x3x3mm key can be filed down slightly if you struggle to get the pulley into place.
- Push the pulley against the motor and lock it down, using a 2mm Allen key. No airgap is allowed between pulley and motor! Please refer to the Trampa motor manual for additional information.

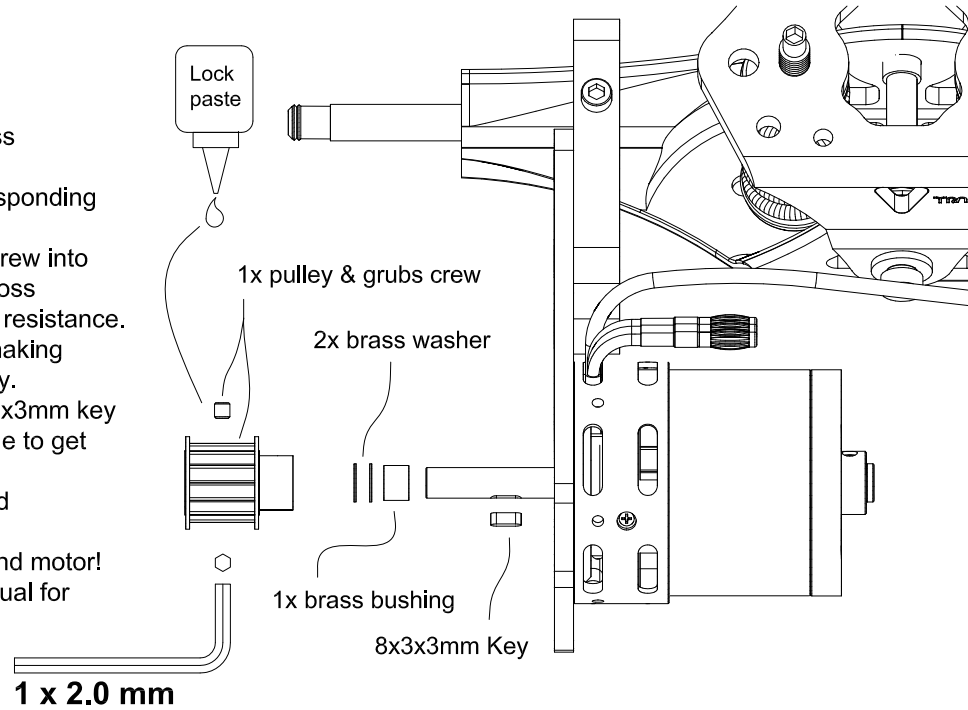

3.2

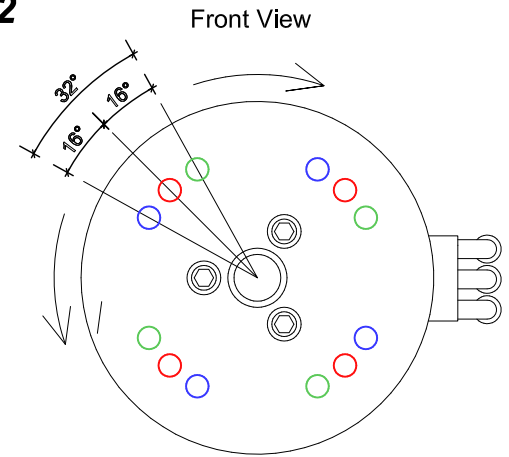

The Trampa motor can be rotated, so that the motor cables sit in the best position. Choose red, blue or green threads to mount the motor to the carbon panel.

3.3

- Rotate the motor into the desired angle for optimal cable position.
- Lay the belt over the pulley
- Present the support bearing housing to motor axle and feed in one 25mm support bearing spacer.
- Feed in one M4x40mm bolt and wind it into the motor base. Make sure you hit the correct thread, as mentioned in image 3.2. Do not tighten bolt down yet.
- Feed in another spacer and bolt, hitting the correct thread on the motor base.
- feed in the last two spacers and bolts.
- The bolt/spacer pointing towards the wheel sits in between the belt!

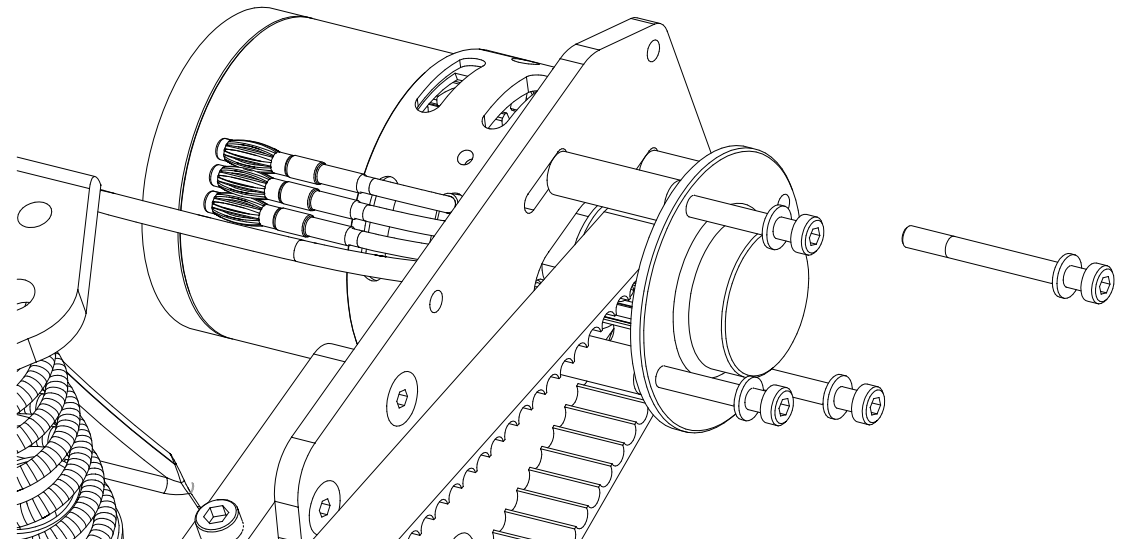
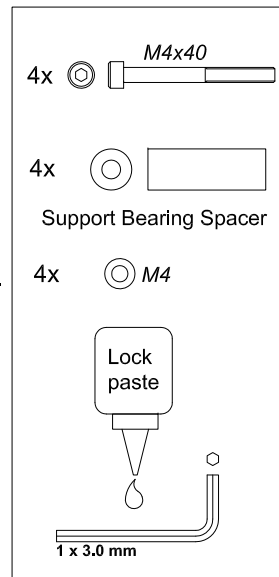

4.1

Wheel assembly and belt tension

- Assemble wheel as described in image 2.3
- Feed the belt over the slave pulley. Rotating the wheel may help to get the belt into position.
- Finally pull the motor backwards to tension the belt. You don't want to tension the belt to crazy! To much tension will only let your bearings suffer.
- Lock down the four M4x40 bolts, using a 3mm Allen key.

